

00-521911

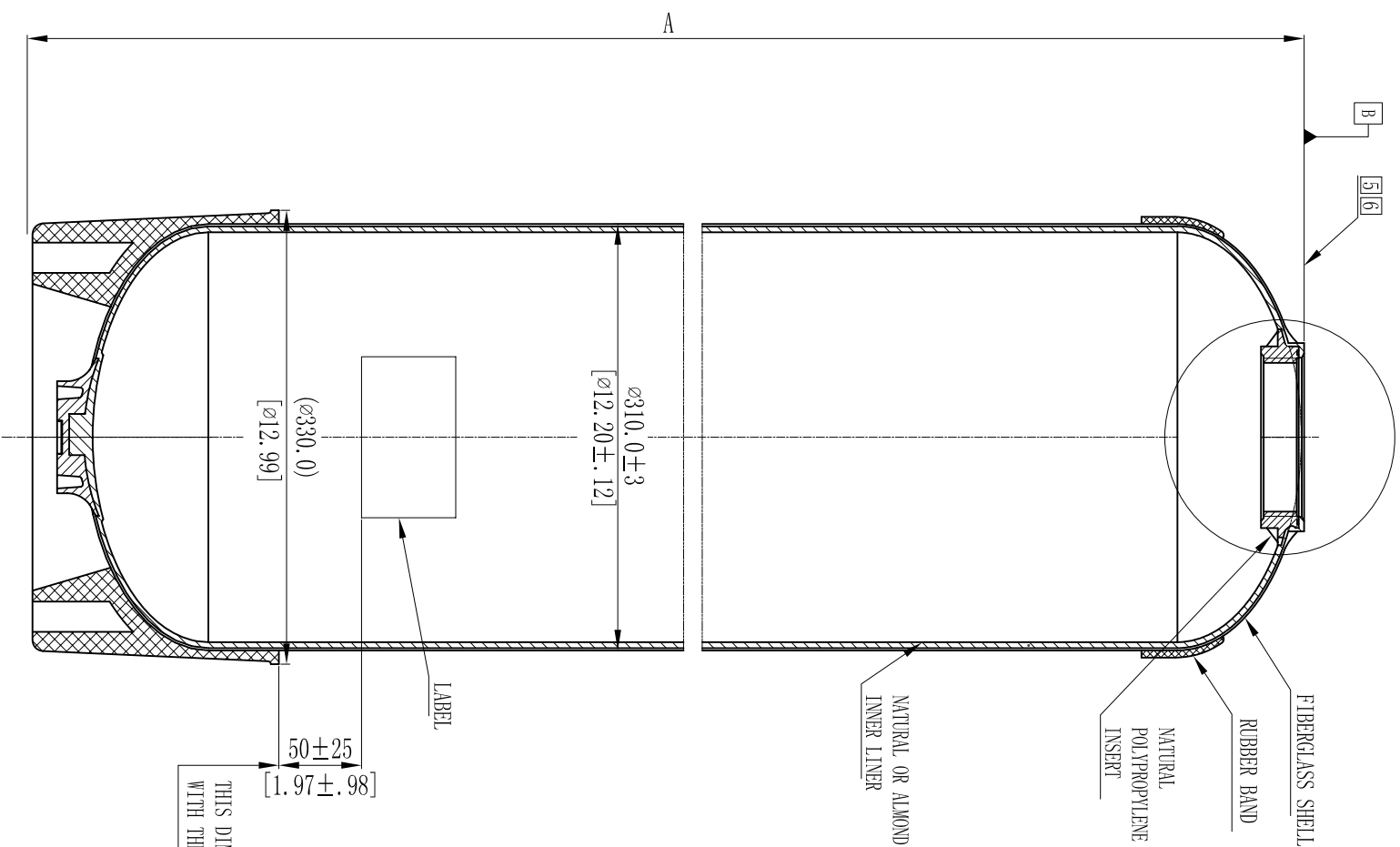

1:2

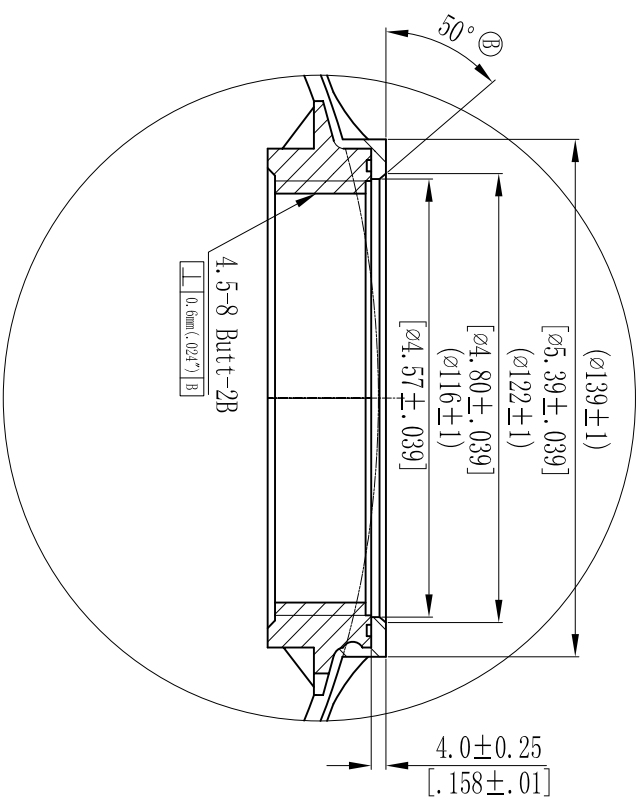

MODEL	A			VOLUME			DOME VOLUME			WEIGHT	
	mm	inch	+/- mm inch	liters	U.S. gal	cubic FT	liters	U.S. gal	cubic FT	Kg	LBS
12x48	1240	48.82	6 .24	89.0	23.51	3.14	3.87	1.02	0.14	16.18	35.60
12x52	1360	53.54	6 .24	97.0	25.63	3.43	3.87	1.02	0.14	16.88	37.14

- NOTES:
- TANK MUST MEET ALL APPLICABLE SPECIFICATIONS OF NSF/ANSI 044 STANDARD, LATEST REVISION.
 - OPERATING SPECIFICATIONS:
 - MAXIMUM WORKING PRESSURE - 150 PSI (10.5BAR)
 - TEMPERATURE RANGE - 34-120° F (1-49°C)
 - MAXIMUM VACUUM - 5"Hg (127mm Hg)
 - VISUAL LINER INSPECTION
 - NO MORE THAN 10 INTERNAL OR EXTERNAL BLEMISHES OR BURNT DEBRIS.
 - NO INTERNAL OR EXTERNAL BLEMISHES OR BURNT DEBRIS LARGER THAN 3×3mm.
 - NO INTERNAL BLEMISHES OR BURNT DEBRIS ALLOWED.
 - ALL GLASS STRANDS FROM FIBERGLASS LINER TO BE BONDED AND COVERED.
 - SURFACE TO BE FREE OF NICKS, SCRATCHES, RESIN AND GLASS.
 - SURFACE FINISH.
 - DIMENSIONS IN PARENTHESIS ARE REFERENCE ONLY.
 - DIMENSIONS IN SQUARE PARENTHESIS ARE INCH UNIT.

THIS DIMENSION CAN BE CHANGED
WITH THE CUSTOMERS' REQUIREMENT

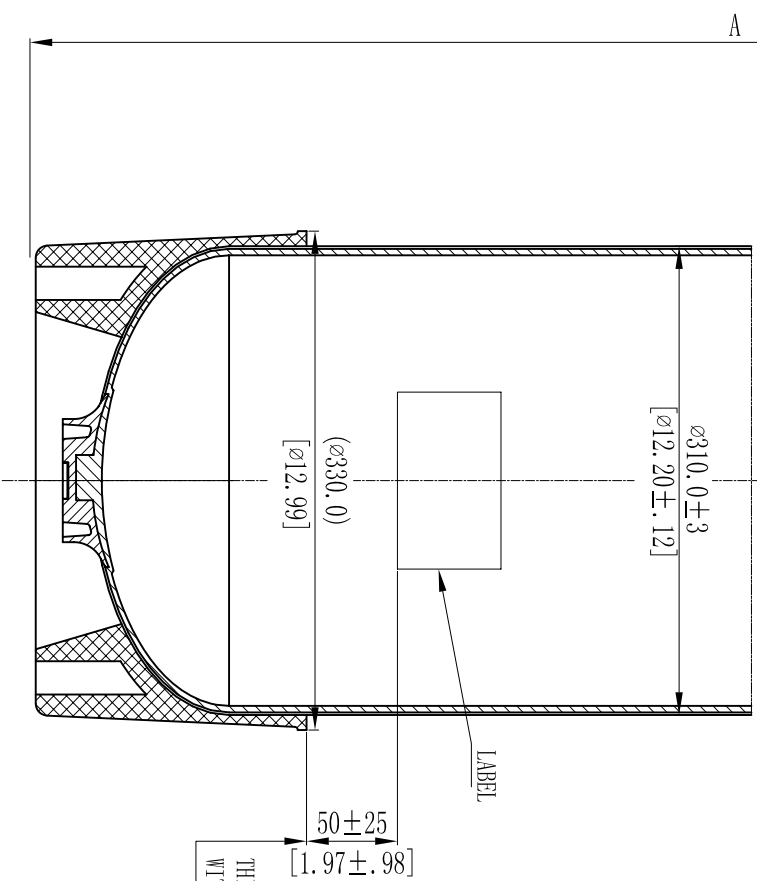

VERSION NO.	3	THIS DRAWING IS DERIVED CORRECTLY WITH THE CHINESE VERSION	DATE	2008.07.21
REPRESENTATIONAL PLASTIC SHRINKAGE (IF NECESSARY):				
SIGNATURE	NAME	DATE		
DESIGN				
INSPECTION				
APPROVAL				
WAVE CYBER (SHANGHAI) CO., LTD.			SCALE	MATERIAL
			1 : 5	
			QUANTITY	SMOOTHNESS
THIS PRODUCT DRAWING CAN NOT BE COPIED AND/OR USED WITHOUT PRIOR WRITTEN APPROVAL OF WAVE CYBER.			PROJECTION	COMPUTER CODE
			DO NOT MEASURE THE DIMENSIONS.	UNIT: MM
			TOTAL PAGE: 1	
			DRAWING NO.	VERSION NO.
			116125-00	3